

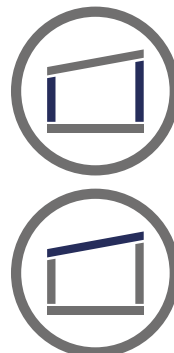

# URSA HOMETEC ROLL 32



## Typical applications:

Twin skin profiled metal clad systems.

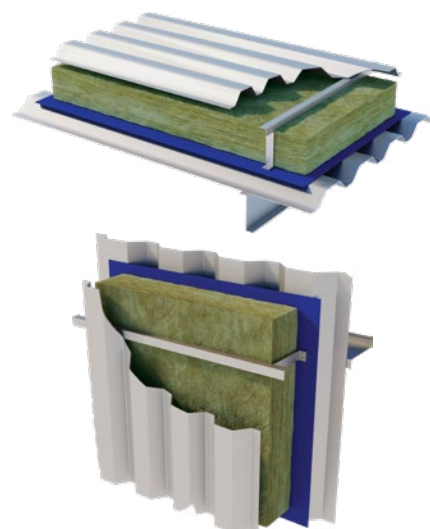

## Description.

URSA HOMETEC ROLL 32 is a non-combustible glass mineral wool insulation roll. The roll is supplied 1200mm wide.



Non-combustible



Thermal Insulation



Recycled Glass Content

## Application.

URSA HOMETEC ROLL 32 is designed to provide thermal and acoustic insulation in the walls and roofs of twin skin profiled metal clad systems and portable & modular buildings.

The product can also be used as thermal and acoustic insulation various applications, including timber frame walls, roofs, and floors.

## Performance.

### Thermal Conductivity:

Declared thermal conductivity ( $\lambda$ ) value of 0.032 W/mK.

### Density:

Manufactured at a nominal density of 32 kg/m<sup>3</sup>.

### Fire Classification:

Deemed non-combustible with a fire classification of Euroclass A1 (the highest possible rating) when tested to EN 13501-1:2018 Reaction to Fire.

# Technical Characteristics.

## Product Specification.

Thickness (mm)	Length (mm)	Width (mm)	Pack Area (m²)	Packs per pallet	Pallet Area (m²)	Thermal Conductivity (W/mK)	Thermal Resistance (m²K/W)	Product Code
60	5400	1200	6.48	18	116.64	0.032	1.85	2134604
80	5400	1200	6.48	18	116.64	0.032	2.50	2134605
101	5000	1200	6.00	18	108.00	0.032	3.15	2141962
120	4500	1200	5.40	18	97.20	0.032	3.75	2145001
140	3700	1200	4.44	18	79.92	0.032	4.35	2145002
160	3300	1200	3.96	18	71.28	0.032	5.00	2145003
180	3000	1200	3.60	18	64.80	0.032	5.60	2145004
200	2600	1200	3.12	18	56.16	0.032	6.25	2140135
220	2500	1200	3.00	18	54.00	0.032	6.85	2142831
240	2400	1200	2.88	18	51.84	0.032	7.50	2144836

Please note that all dimensions are nominal.

## Additional Information.

### Vapour Resistivity.

The product has a nominal vapour resistivity of 5 MNs/gm.

### Environmental Credentials.

- The primary packaging on our products (rolls and slabs) and pallets (the shrink hood) are wrapped in low-density polyethylene (LDPE4) plastic, which contains a minimum 30% recycled material and is fully recyclable. The secondary packaging on our products (grouping rolls and slabs into modules of 3-6 packs) is low-density polyethylene (LDPE4) virgin plastic. Before recycling, please consult your local authority for guidance.
- ISO 14001:2015 – Environmental Management Systems (EMS) certified. Certificate number: BQA\_EMS\_C\_2016673.
- Contains no ozone-depleting substances or greenhouse gases.
- Manufactured from up to 73% recycled glass.
- Generic BRE Green Guide Rating of A+.

### Standards and Approvals.

Manufactured in accordance with:

- EN 13162:2012+A1:2015 Thermal insulation products for buildings – Factory made mineral wool (MW) products.
- EN 13172: 2012 Thermal insulation products – Evaluation of conformity.
- ISO 9001:2015 – Quality Management Systems (QMS). Certificate number: 01 100 1300949.

### Certification.

- CE marked to EN 13162:2012+A1:2015. Certificate number: 1163-CPR-0051.

### EUCEB (European Certification Board of Mineral Wool Products).

All URSA glass mineral wool products are made of non-classified fibres and are certified by EUCEB. EUCEB is a voluntary initiative by the mineral wool industry. It is an independent certification authority that guarantees that products are made of fibres which comply with the exoneration criteria for carcinogenicity (Note Q) of the Regulation (EC) 1272/2008.

Certificate number: BEUC-511-46-376-46.

### Handling & Storage.

The product should be stored properly and handled in such a way as to ensure that the product remains clean and undamaged.

The product is supplied compression packed in polythene to provide short term protection only. For long term protection, the product must be stored indoors, or under a waterproof covering and off the ground to protect from weather damage. The product should not be left permanently exposed to the elements.

All URSA products are non-hygroscopic, will not rot, degrade, or sustain vermin and will not encourage the growth of mould, bacteria, or fungi.

### URSA TERRA.

Developed in 2009, URSA TERRA is the latest in glass mineral wool technology. A combination of our unique production processes and product formulation delivers significant advancements across our expansive range of insulation products.



Etex UK Insulation Limited. Thistle Industrial Estate, Kerse Road, Stirling, Scotland FK7 7QQ [ursa-uk.co.uk](http://ursa-uk.co.uk)

Technical: T. 0808 1645 134 | E. [technicalursa.uk@etexgroup.com](mailto:technicalursa.uk@etexgroup.com) | Customer Services: T. 01786 451170 | E. [customerservice.stirling@etexgroup.com](mailto:customerservice.stirling@etexgroup.com)